

SURVEY FORM TRACTION

VERSION 1.0

Please be advised this form is to be completed electronically. To confirm a text box, simply tick
 Please send this completed form to: sales@universalliftsolutions.com

YOUR DETAILS

Company Name
 Contact
 Contact Number

SITE INFORMATION

Site Reference
 Delivery Date Required / /

(1) CONTROLLER REQUIREMENTS

Modernisation New Installation

(2) STANDARDS

EN81-1/2	EN81-71	
EN81-A3	EN81-72	
EN81-20/50	EN81-73	
EN81-21	BS9999	
EN81-70	HTM08	HTM08* Hospital Specification

(3) MOTOR/MACHINE DETAILS

Geared	Gearless AC	Synchronous	Asynchronous
Gearbox Ratio	Gearless DC	A machine whose rotor speed and the speed of the strator magnetic field is equal: B 1 B G 1 %&.\$Z#D	A motor is a machine whose rotor rotates at the speed less than the synchronous speed: B O B G
Sheave Diameter			
Rope Ratio			
Existing	Yes	No	

MOTOR DETAILS

AMPS FLC	Volts
KW	Hz
HP	Poles
RPM	Lift Speed m/s
Cos-ph	

Motor Encoder Details	Type	Voltage	PPR
------------------------------	------	---------	-----

(4) BRAKE DETAILS

Brake Pick Voltage	Retiring Ramp Voltage
Brake Hold Voltage	
Brake Amps	

(5) MAINS SUPPLY

3 Phase	Neutral Available	Yes	No
---------	-------------------	-----	----

(6) CAR DOORS

Door Operator Type	Door Operator Voltage	AC	DC
Retiring Cam Voltage	Selective Opening	Yes	No
	Manual Doors Car/Land	Yes	No
Total Number of Car Door Sides	Power Doors Car/Land	Yes	No
	Semi - Auto Land	Yes	No

(7) LOAD WEIGHING DEVICE

Type

Location	Under Car	Via Suspension Ropes	Crown Bar
-----------------	-----------	----------------------	-----------

(8) CONTROLLER LOCATION

MRL	Door Post	Motor Room	MRL Mod Special Controller
-----	-----------	------------	----------------------------

Plinth Required	Yes	No	Plinth Height
------------------------	-----	----	---------------

Controller Mounting Position	Wall	Floor
-------------------------------------	------	-------

Controller Cabinet Size (Width x Height x Depth) in mm

Wall Mounted 600 x 1000 x 200	Wall Mounted 800 x 1000 x 300
Floor Mounted 800 x 1800 x 400	Floor Mounted 1000 x 1800 x 400
MRL External Inverter 400 x 2000 x 200	MRL Internal Inverter 400 x 2000 x 300

Controller Finish	Satin Stainless Steel	RAL
--------------------------	-----------------------	-----

(9) DIMENSIONS

Mark Entrances Front and Rear with:

*Cable lengths for landing indicator/push station nodes are only available in 5, 7, 10, 15, 20, 25 and 30m

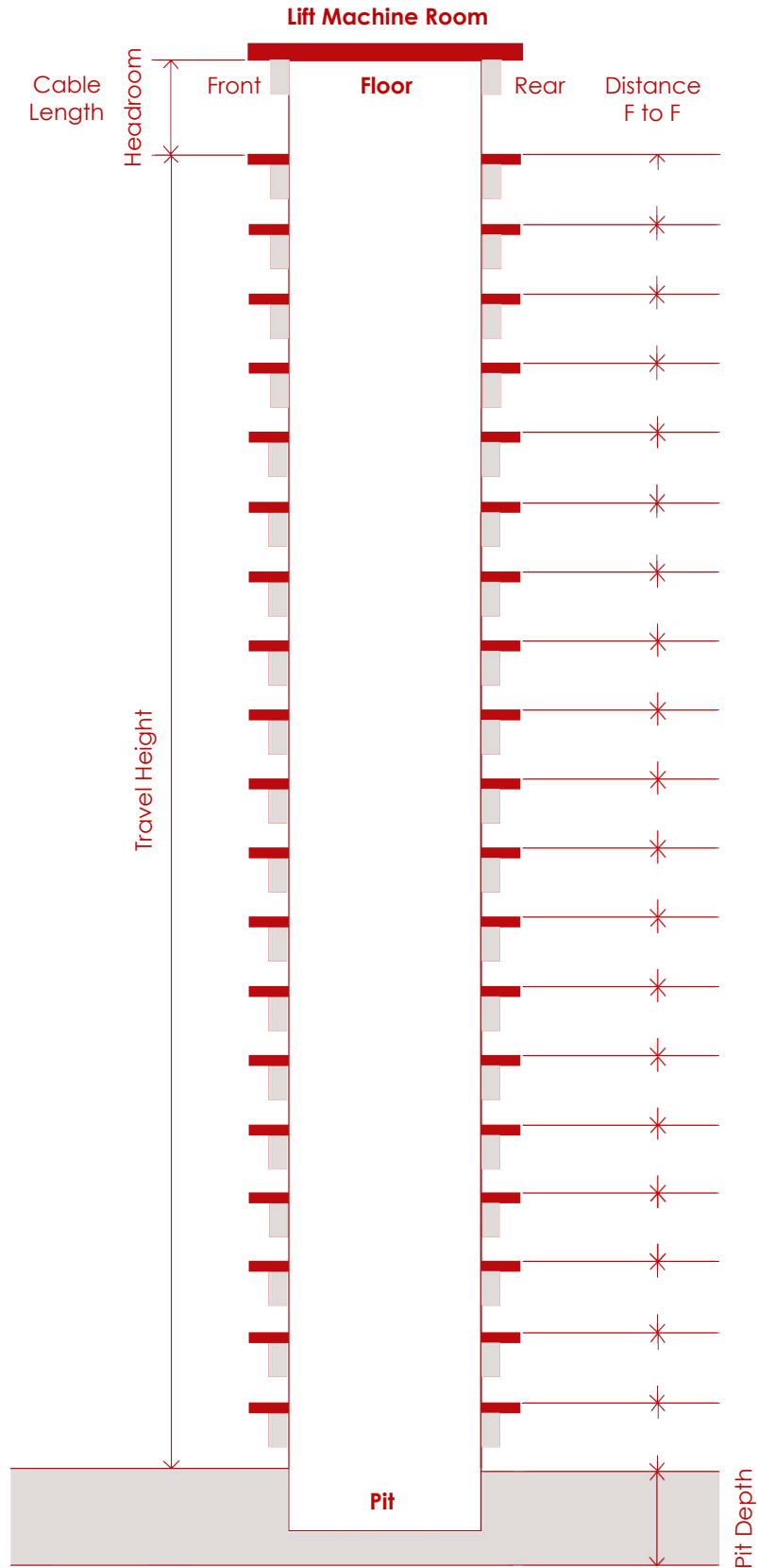

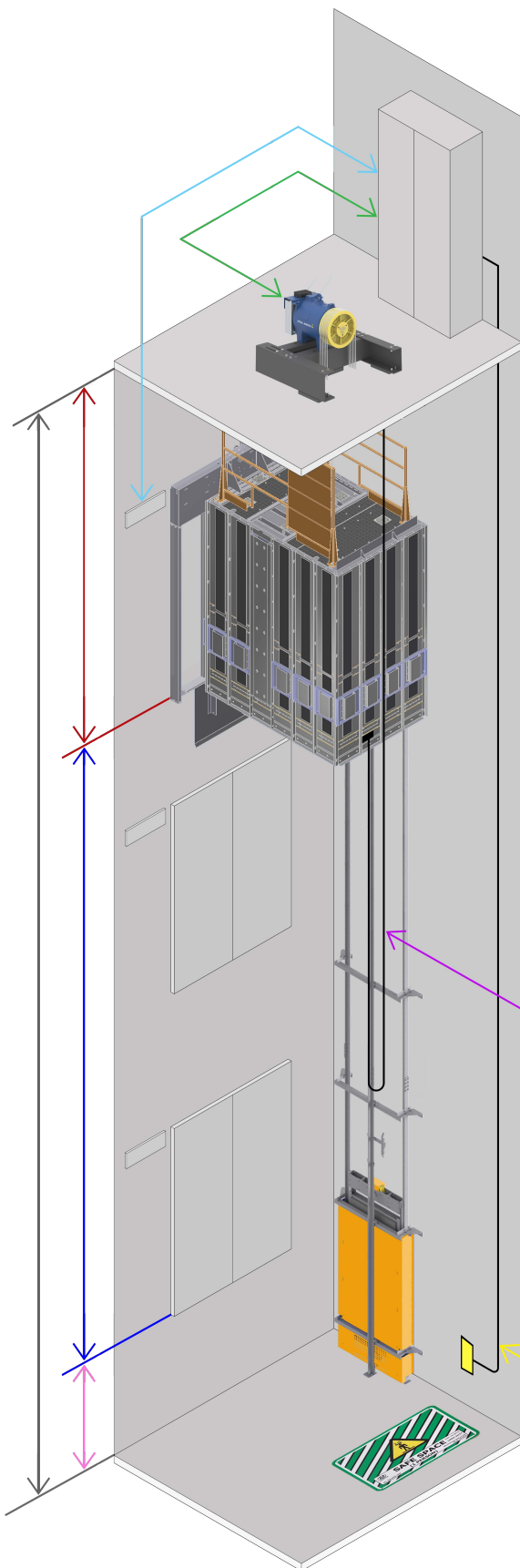

Controller to Indicator Dimension mm

Controller to Motor Dimension mm

Shaft Headroom Dimension mm

Shaft Height mm

Traveling Height mm

Trailer Height mm

Shaft Pit mm

Pit Pendant Length mm

(10) SYSTEM CONTROL

Full Collective	Down Collective	Destination Control	No. of Lifts in Group
Call & Send	No. of Push Risers	Lift Riser Allocation	
Call Buttons (24 Volt Standard)		Single Illumination	Dual Illumination

*Special Requirements: Please provide details in Section (16)

(11) LANDING POSITION INDICATORS

TFT 45 = 2.8"

TFT 110 = 5"

TFT 210 = 10.4"

Quantity Required

(12) CAR POSITION INDICATORS

TFT 110 = 5"

TFT 210 = 10.4"

Quantity Required

(13) EMERGENCY OPERATION TRAVEL

ARD = Automatic Rescue Device

ARD to main floor	Yes	No
ARD to nearest floor	Yes	No

(14) EMERGENCY BRAKE RESCUE OPERATION

*Please be advised this is supplied with all new MRL package lifts as standard

Yes	No
-----	----

(15) SUPPLEMENTARY ITEMS

Regen Drive

Installation Pendant Cable Length

LED Shaft Lights with multiple way switching	Yes	No	Length
--	-----	----	--------

LED Shaft Lights with additional 3 hour emergency back up	Yes	No	Length
---	-----	----	--------

(16) ADDITIONAL COMMENTS

St Andrews Business Park
Queens Lane,
Mold, CH7 1XB
Tel: 01352 706211
www.universalliftsolutions.co.uk